

LOGSPE

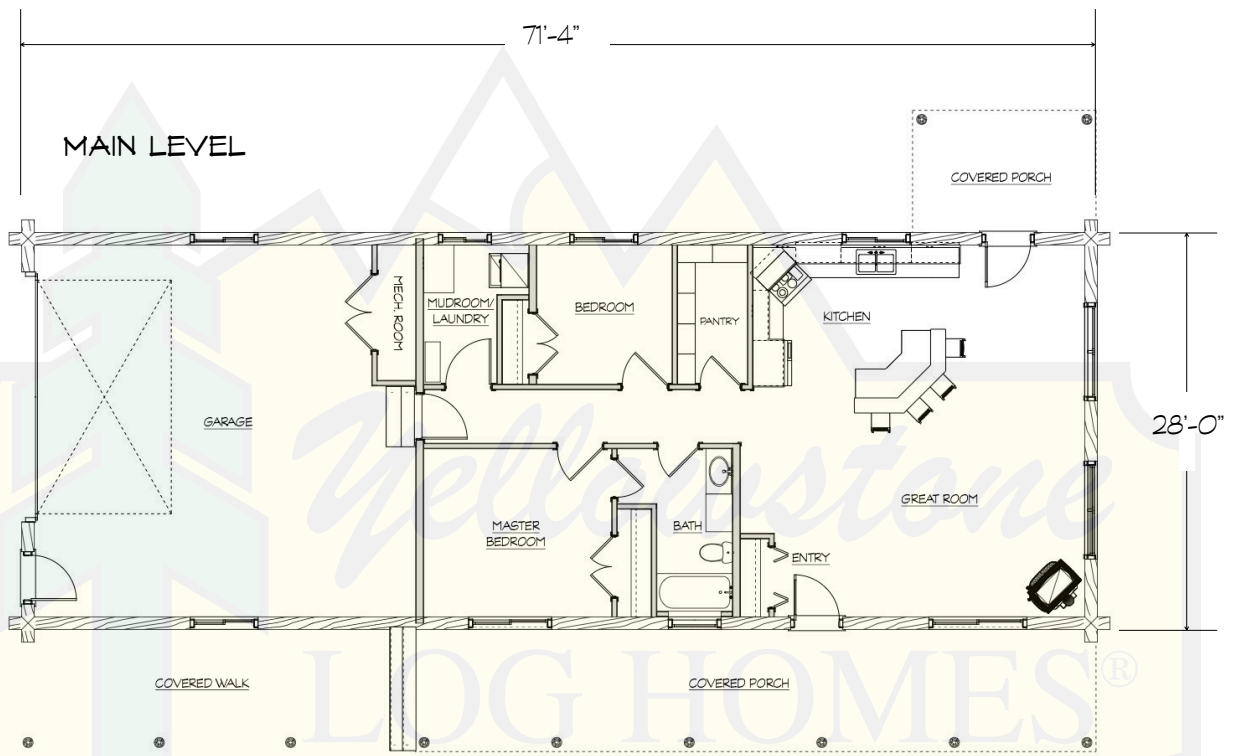

280 N Yellowstone Hwy
Rigby, ID 83442

phone: (208) 745-8108
fax: (208) 745-8525

sales@yellowstonelohomes.com
www.yellowstonelohomes.com

MAIN LEVEL	1170 SF
LIVING AREA	1170 SF
GARAGE	676 SF
TOTAL AREA	1846 SF

