

# HIDEOUT

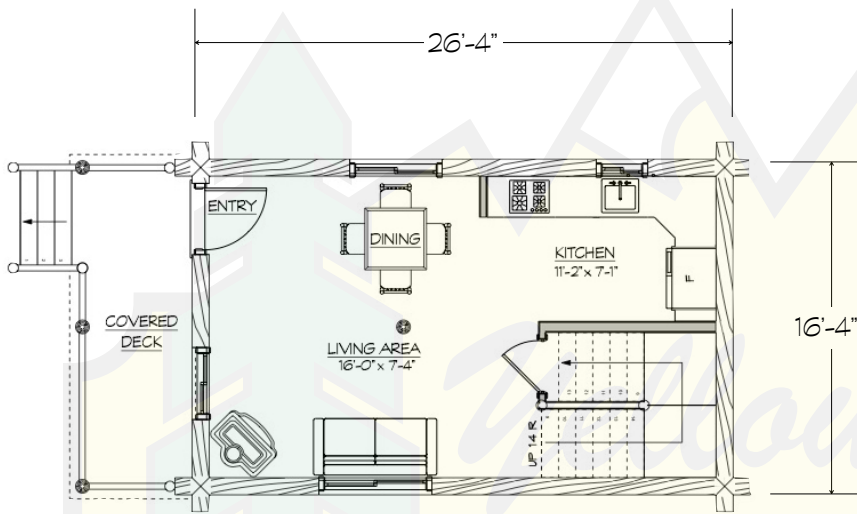

MAIN LEVEL

MAIN LEVEL	416 SF
SECOND LEVEL	389 SF
TOTAL AREA	805 SF



SECOND LEVEL

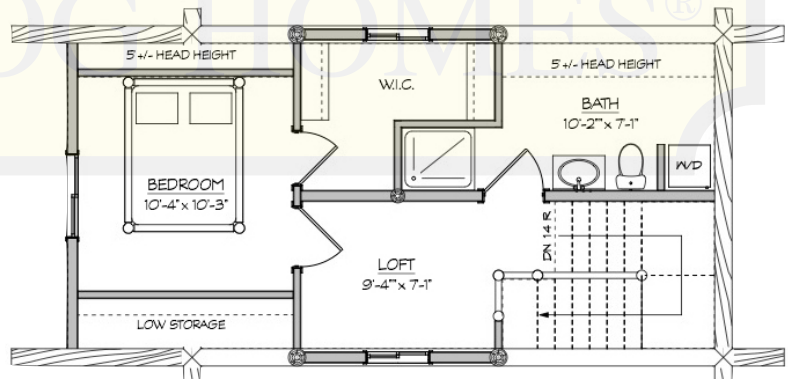

280 N Yellowstone Hwy  
Rigby, ID 83442

phone: (208) 745-8108  
fax: (208) 745-8525

sales@yellowstoneloghomes.com  
www.yellowstoneloghomes.com